



Dispositivo di scorrimento lineare SLDS.2 Linear unit SLDS.2

Caratteristiche principali :

- Corsa modulare regolabile con intervalli di 0,1 mm.
- Cilindro pneumatico con alesaggio 63, 80 e 125 mm.
- 2 guide lineari con 4 carrelli
- Ripetibilità : $\pm 0,01$ mm.
- Sistema di bloccaggio con chiusure (SBC)
- Frenatura cilindro in posizione arretrata
- Deceleratore in posizione avanzata
- Sensori induttivi in posizione avanzata e arretrata
- Ripari in lamiera o a soffietto

Main characteristics:

- Adjustable modular stroke 0,1 mm. intervals
- Pneumatic cylinder with 63, 80 and 125 mm. bore
- 2 linear rails and 4 runner blocks
- Repeatability : $\pm 0,01$ mm.
- Power Clamp locking system (SBC)
- Cylinder cushioning in the backwards position
- Shock absorber in the forward position
- Proximity switches in the backwards and forward position
- Metal covers or bellows

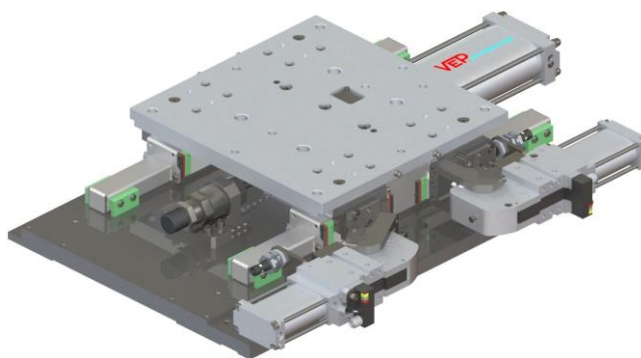

[PDF](#)



[3D Step](#)



[Index](#)

Indice.

Index.

Pagina Page	Descrizione Description	
1	Caratteristiche principali Main characteristics	
2	Codice d'ordine Ordering example	
3-4	Pagina dimensionale Dimensional page	SLDS63.2
5-6		SLDS80.2
7-8		SLDS125.2
9	Schema sensore induttivo CP40.3 - CP50.1 Inductive sensor diagram for CP40.3 - CP50.1	
10	Schema finecorsa slitta lineare / Schema pneumatico / Consumo aria Linear unit limit switch diagram / Pneumatic plan / Air consumption	
11-12	Ricambi / Spare parts	
13	Note / Notes	



Codice d'ordine. Ordering example.

SLDS80.2	-	100/60	-	L	-	S1	-	H
----------	---	--------	---	---	---	----	---	---

SLDS63.2
alesaggio Ø 63 mm.,
4 carrelli, carico max. 150 Kg
cylinder bore Ø 63 mm.,
4 runner blocks, max. load 150 Kg

SLDS80.2
alesaggio Ø 80 mm.,
4 carrelli, carico max. 250 Kg
cylinder bore Ø 80 mm.,
4 runner blocks, max. load 250 Kg

SLDS125.2
alesaggio Ø 125 mm.,
4 carrelli, carico max. 600 Kg
cylinder bore Ø 125 mm.,
4 runner blocks, max. load 600 Kg

Sistema di bloccaggio SBC :
SBC locking device position :

X : Senza bloccaggi / *Without locking*

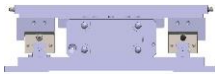

L : Bloccaggi sul lato Sx / *Locking on the left side*
(Posizione standard di fornitura) *Standard delivery position*

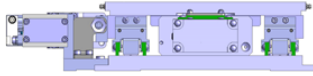

R : Bloccaggi sul lato Dx / *Locking on the right side*

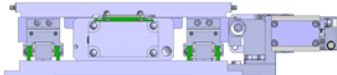

Tipo <i>Type</i>	Corsa <i>Adjustable stroke</i>
50	5÷50 mm.
100	51÷100 mm.
150	101÷150 mm.
200	151÷200 mm.
300	201÷300 mm.
400	301÷400 mm.
500	401÷500 mm.

La corsa è regolabile ad intervalli di 0.1mm.
The stroke of the linear unit is adjustable with steps of 0.1mm.

Tipologie standard / *Standard types:*

SLDS63.2	50	100	150	200	300	400	500
SLDS80.2	50	100	150	200	300	400	500
SLDS125.2	50	100	150	200	300	400	500

Tipologie 400 e 500 su richiesta
Types 400 and 500 on request

Riparo :
Cover :

X : Senza riparo
Without cover

S1 : Con riparo in lamiera (standard)
With metal sheet cover (standard)

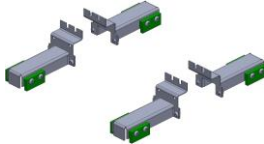

S4* : Con soffiETTO anteriore + posteriore
With bellows on the front and back side



 * Il riparo S4 è una costruzione speciale, ed è disponibile solo previa consultazione ed approvazione da parte di VEP Automation.
**Cover type S4 is a special solution. Available only after consultation and approval of VEP Automation.*

ATTENZIONE → Riparo S4 non disponibile su SLDS63.2 corsa 50mm.
ATTENTION → Cover S4 not available for SLDS63.2 stroke 50mm.

Posizione di montaggio :
Mounting position :

H : Orizzontale (standard)
Horizontal (standard)

V : Applicazione speciale con posizione di montaggio verticale o inclinato **SOLO** dopo approvazione da parte della VEP Automation.
*Special application with vertical or tilted mounting position **ONLY** after the approval of VEP Automation*

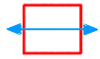

SLDS63.2-... / ...-X-H

Slitta lineare, D. 63, 4 carrelli, Blocco SBC, Corsa vario
 Linear unit, D. 63, 4 Runner blocks, Clamp locking sys., Various stroke

Predisposizione fissaggio SBC
 SBC connection holes

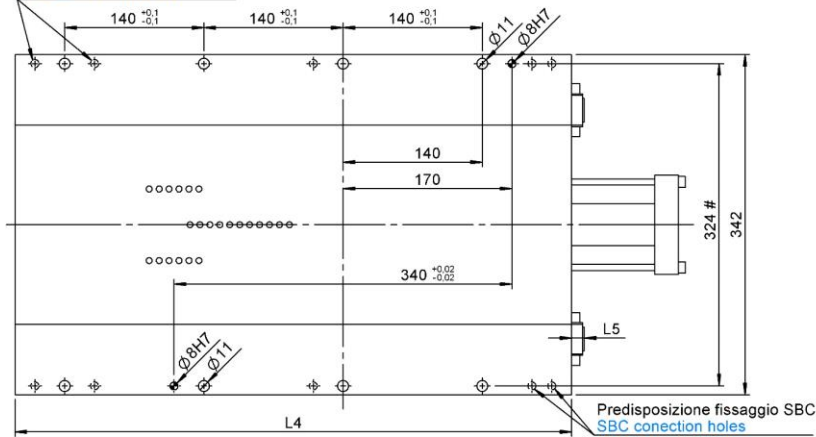

Riparo stelo cilindro :
 - Disponibili con riparo **S1** per
 tipologia **150** e superiori
 Cylinder rod cover :
 - Available with **S1** cover for
 type **150** and above

** Carico max.
 ** Max. load

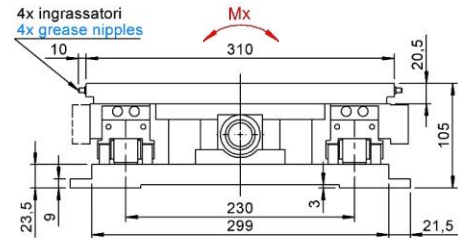
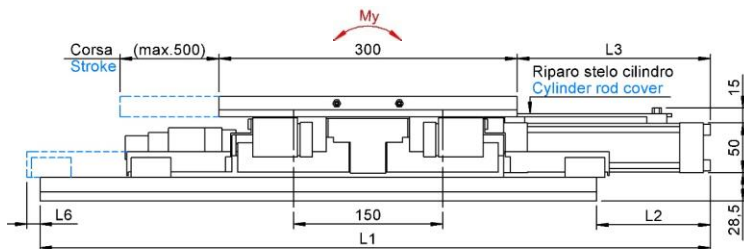

Deceleratore
 Shock absorber

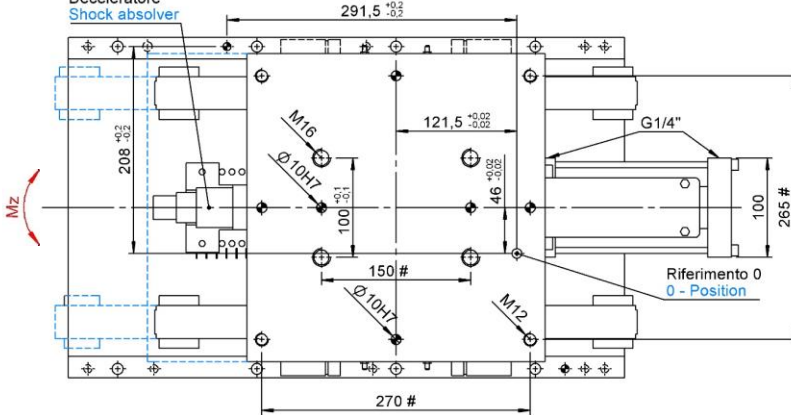

Tolleranze su corsa :
 - fino a corsa 300 mm. : ± 0,03 mm.
 - corsa 400 mm. & 500 mm. : ± 0,05 mm.
 Stroke tolerances :
 - up to stroke 300 mm. : ± 0,03 mm.
 - stroke 400 mm. & 500 mm. : ± 0,05 mm.

*** applicazione speciale
 SOLO dopo approvazione da
 parte della **VEP Automation**.
 *** special application
 ONLY after the approval of
VEP Automation.

Tolleranze : fori spina ± 0.02, fori filettati ± 0.1 # Tolerances : dowel holes ± 0.02, screw holes ± 0.1

Modello Type	Tipo Type	Alesaggio Cylinder bore	Corsa regolabile Adjustable stroke	Peso Weight	L1	L2	L3	L4	L5	Consumo aria (5 bar) Air consumption (5 bar)	Pressione d'esercizio Working pressure
		[mm.]	[mm.]							[kg]	[mm.]
SLDS63.2-50	50	63	5 - 50	54	625	65	145	560	---	1,9	4 - 8
SLDS63.2-100	100		50-100	54	675	115	195	560	14	3,6	
SLDS63.2-150	150		100-150	62	825	165	245	660	64	5,4	
SLDS63.2-200	200		150-200	62	875	215	295	660	114	7,2	
SLDS63.2-300	300		200-300	70	1075	315	395	760	214	10,7	
SLDS63.2-400	400		300-400	78	1275	415	495	860	314	14,3	
SLDS63.2-500	500		400-500	86	1475	515	595	960	414	17,9	

** Carico max. applicabile (5 bar) ** Max. applicable load (5 bar)		Momento dinamico max. Dynamic torque max			Momento statico max. Static moment max.			Spinta max. Max. Thrust force (5 bar)
[kg]		[Nm]			[Nm]			[N]
Installazione orizzontale Horizontal installation	Installazione verticale Vertical installation	Mx	My	Mz	Mx	My	Mz	1480
150	65***	560	280	220	840	430	330	

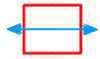

Dispositivo di scorrimento lineare con bloccaggio con chiusure Linear unit with clamps locking system

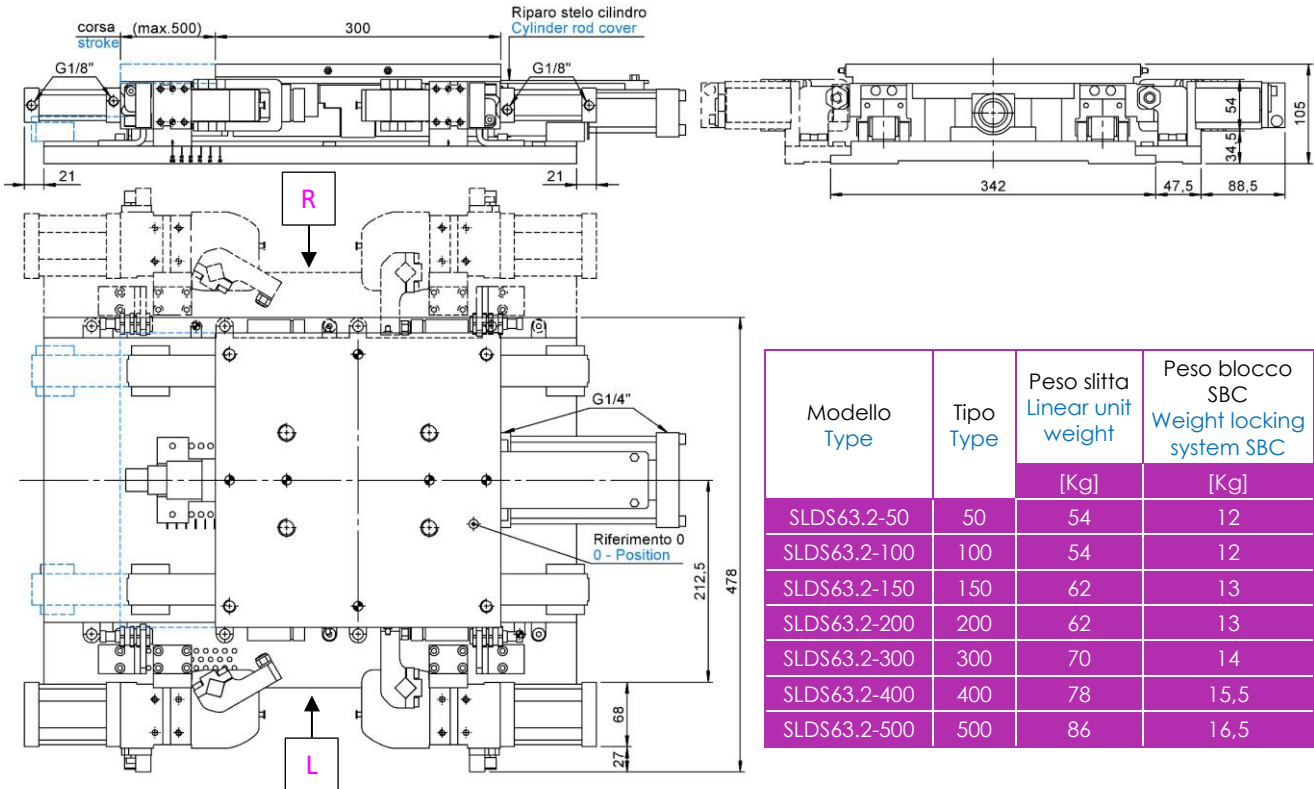

Modello Type	Tipo Type	Peso slitta Linear unit weight	Peso blocco SBC Weight locking system SBC
		[Kg]	[Kg]
SLDS63.2-50	50	54	12
SLDS63.2-100	100	54	12
SLDS63.2-150	150	62	13
SLDS63.2-200	200	62	13
SLDS63.2-300	300	70	14
SLDS63.2-400	400	78	15,5
SLDS63.2-500	500	86	16,5

Regolazione della corsa slitta Slide stroke adjustment

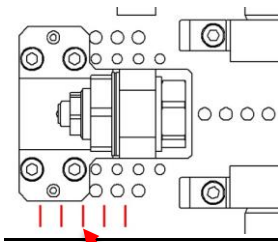

Macro Regolazione (Steps 10 mm.)

Fincorsa anteriore + deceleratore.

Spostando la staffa (foratura sulla piastra base) è possibile modificare la corsa della slitta con un passo di 10 mm.

Coarse adjustment (Steps 10 mm.)

Front end stop + shock absorber. By moving the bracket (holes on the plate), the slide stroke can be changed in 10 mm. increments.

Modello Type	Corsa cilindro Cylinder stroke	Corsa slitta corta Short slide stroke	Corsa slitta lunga Long slide stroke
SLDS63.2-50	50	5 ÷ 50	
SLDS63.2-100	100		51 ÷ 100
SLDS63.2-150	150	101 ÷ 150	
SLDS63.2-200	200		151 ÷ 200
SLDS63.2-300	300	201 ÷ 250	251 ÷ 300
SLDS63.2-400	400	301 ÷ 350	351 ÷ 400
SLDS63.2-400	500	401 ÷ 450	451 ÷ 500

Nella tabella in alto sono indicate le varie tipologie di slitte con le relative corse massime e minime possibili.

The table above shows the various types of slides with their maximum and minimum possible strokes.

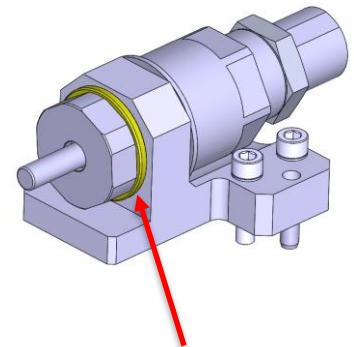

Micro Regolazione

Con spessori interposti tra la staffa e la ghiera. Sostituendo/aggiungendo spessori calibrati è possibile modificare la corsa. Spessori standard da 3/4/5 mm.

Fine adjustment

With Shims between bracket and ring nut. By replacing/adding calibrated shims, the stroke can be modified. Standard shims of 3/4/5 mm.

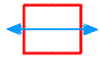

SLDS80.2-... / ...-X-H

Slitta lineare, D. 80, 4 carrelli, Blocco SBC, Corsa vario
 Linear unit, D. 80, 4 Runner blocks, Clamp locking sys., Various stroke

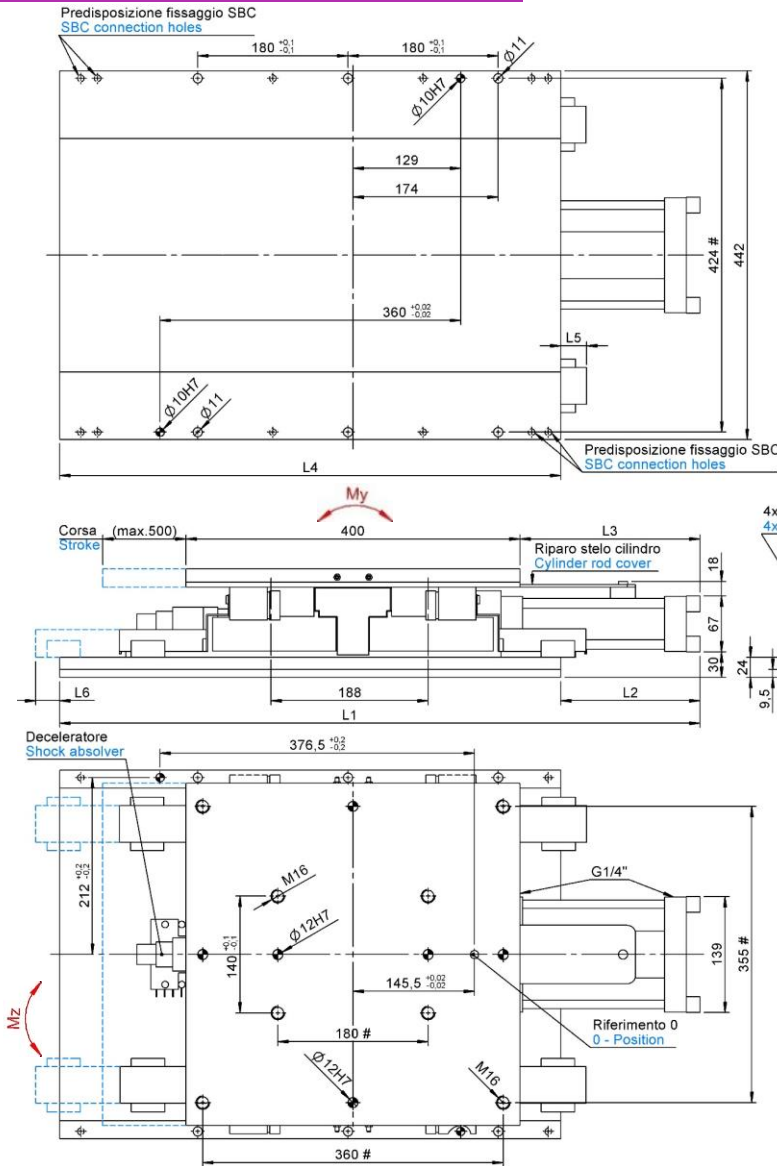

Riparo stelo cilindro :
 - Disponibili con riparo **S1** per
 tipologia **150** e superiori
 Cylinder rod cover :
 - Available with **S1** cover for
 type **150** and above

** Carico max.
 ** Max. load

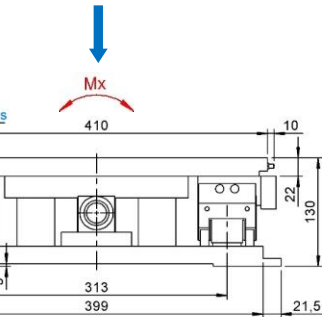

Tolleranze su corsa:
 - fino a corsa 300 mm. : ± 0,03 mm.
 - corsa 400 mm. & 500 mm.: ± 0,05 mm.
 Stroke tolerances :
 - up to stroke 300 mm. : ± 0,03 mm.
 - stroke 400 mm. & 500 mm. : ± 0,05 mm.
 *** applicazione speciale
SOLO dopo approvazione da
parte della VEP Automation.
 *** special application
ONLY after the approval of
VEP Automation

Tolleranze : fori spina ± 0.02, fori filettati ± 0.1 # Tolerances : dowel holes ± 0.02, screw holes ± 0.1

Modello Type	Tipo Type	Alesaggio Cylinder bore	Corsa regolabile Adjustable stroke	Peso Weight	L1	L2	L3	L4	L5	Consumo aria (5 bar) Air consumption (5 bar)	Pressione d'esercizio Working pressure
		[mm.]	[mm.]	[kg]	[mm.]	[mm.]	[mm.]	[mm.]	[mm.]	[l]	[bar]
SLDS80.2-50	50	80	5 - 50	90	717	117	166	600	---	3,0	4 - 8
SLDS80.2-100	100		50-100	91	767	167	216	600	30	5,9	
SLDS80.2-150	150		100-150	100,5	917	217	266	700	80	8,8	
SLDS80.2-200	200		150-200	101,5	967	267	316	700	130	11,6	
SLDS80.2-300	300		200-300	112,5	1167	367	416	800	230	17,4	
SLDS80.2-400	400		300-400	124	1367	467	516	900	330	23,1	
SLDS80.2-500	500		400-500	134,5	1567	567	616	1000	430	28,9	

** Carico max. applicabile (5 bar) ** Max. applicable load (5 bar)		Momento dinamico max. Dynamic torque max			Momento statico max. Static moment max.			Spinta max. Max. Thrust force (5 bar)
[kg]		[Nm]			[Nm]			[N]
Installazione orizzontale Horizontal installation	Installazione verticale Vertical installation	Mx	My	Mz	Mx	My	Mz	2390
250	90***	1270	640	500	1930	980	760	

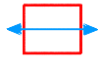

Dispositivo di scorrimento lineare con bloccaggio con chiusure Linear unit with clamps locking system

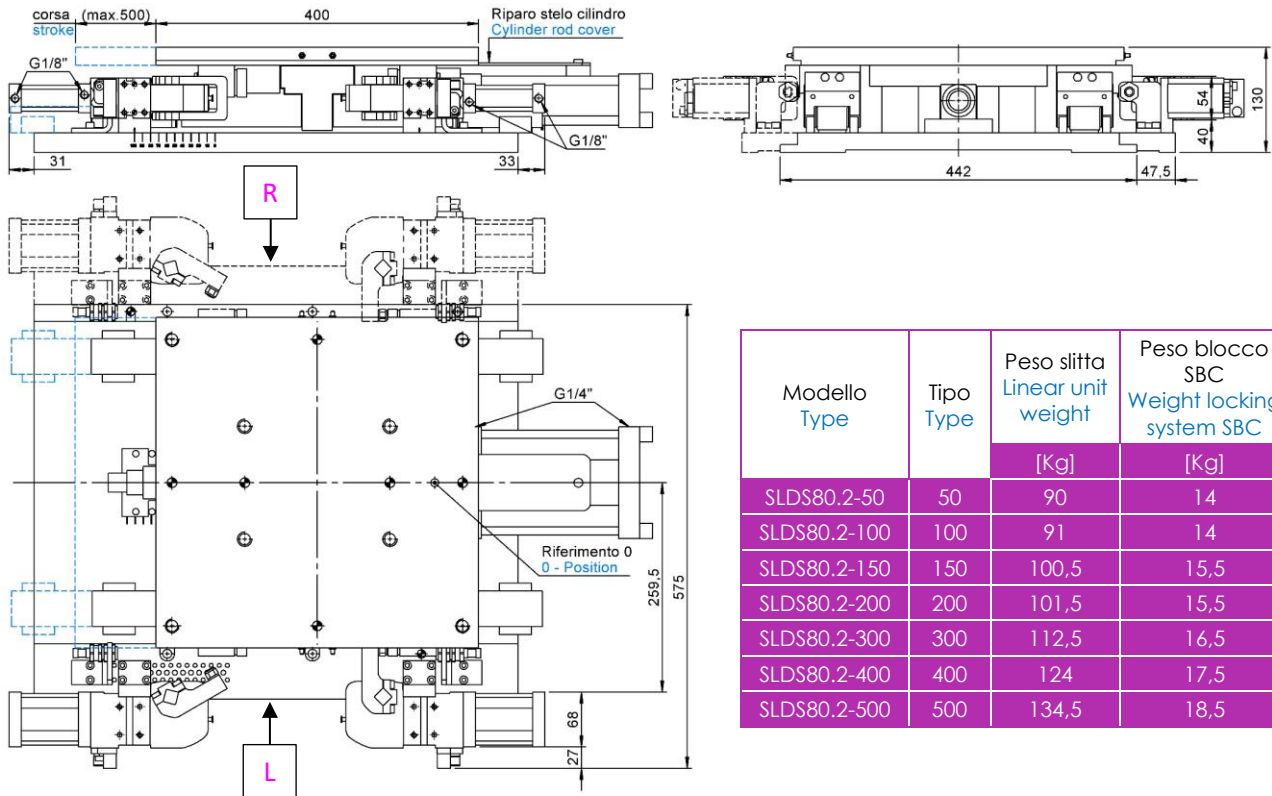

Modello Type	Tipo Type	Peso slitta Linear unit weight	Peso blocco SBC Weight locking system SBC
		[Kg]	[Kg]
SLDS80.2-50	50	90	14
SLDS80.2-100	100	91	14
SLDS80.2-150	150	100,5	15,5
SLDS80.2-200	200	101,5	15,5
SLDS80.2-300	300	112,5	16,5
SLDS80.2-400	400	124	17,5
SLDS80.2-500	500	134,5	18,5

Regolazione della corsa slitta Slide stroke adjustment

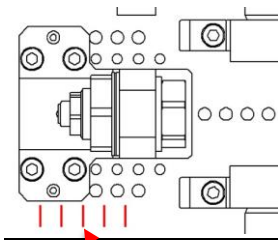

Macro Regolazione (Steps 10 mm.)

Finecorsa anteriore + deceleratore. Spostando la staffa (foratura sulla piastra base) è possibile modificare la corsa della slitta con un passo di 10 mm.

Coarse adjustment (Steps 10 mm.)

Front end stop + shock absorber. By moving the bracket (holes on the plate), the slide stroke can be changed in 10 mm. increments.

Modello Type	Corsa cilindro Cylinder stroke	Corsa slitta corta Short slide stroke	Corsa slitta lunga Long slide stroke
SLDS80.2-50	50	5 ÷ 50	
SLDS80.2-100	100		51 ÷ 100
SLDS80.2-150	150	101 ÷ 150	
SLDS80.2-200	200		151 ÷ 200
SLDS80.2-300	300	201 ÷ 250	251 ÷ 300
SLDS80.2-400	400	301 ÷ 350	351 ÷ 400
SLDS80.2-400	500	401 ÷ 450	451 ÷ 500

Nella tabella in alto sono indicate le varie tipologie di slitte con le relative corse massime e minime possibili.

The table above shows the various types of slides with their maximum and minimum possible strokes.

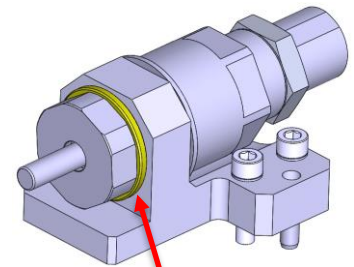

Micro Regolazione

Con spessori interposti tra la staffa e la ghiera. Sostituendo/aggiungendo spessori calibrati è possibile modificare la corsa. Spessori standard da 3/4/5 mm.

Fine adjustment

With Shims between bracket and ring nut. By replacing/adding calibrated shims, the stroke can be modified. Standard shims of 3/4/5 mm.

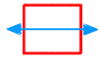

SLDS125.2-... / ...-X-H

Slitta lineare, D. 125, 4 carrelli, Blocco SBC, Corsa vario
 Linear unit, D. 125, 4 Runner blocks, Clamp locking sys.,
 Various stroke

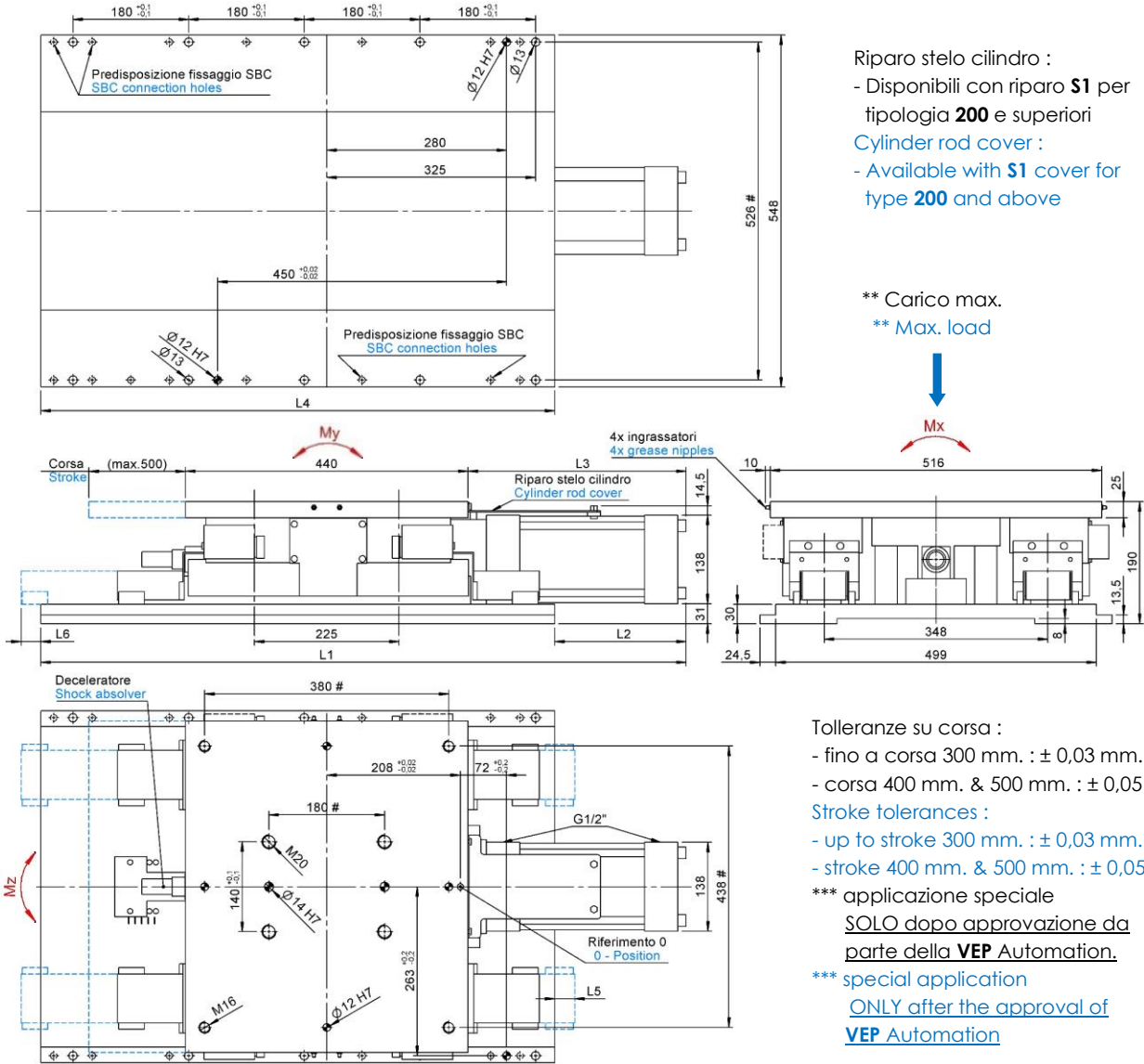

Riparo stelo cilindro :
 - Disponibili con riparo **S1** per
 tipologia **200** e superiori
 Cylinder rod cover :
 - Available with **S1** cover for
 type **200** and above

** Carico max.
 ** Max. load

Tolleranze su corsa :
 - fino a corsa 300 mm. : ± 0,03 mm.
 - corsa 400 mm. & 500 mm. : ± 0,05 mm.
 Stroke tolerances :
 - up to stroke 300 mm. : ± 0,03 mm.
 - stroke 400 mm. & 500 mm. : ± 0,05 mm.
 *** applicazione speciale
SOLO dopo approvazione da
parte della VEP Automation.
 *** special application
ONLY after the approval of
VEP Automation

Tolleranze : fori spina ± 0.02, fori filettati ± 0.1 # Tolerances : dowel holes ± 0.02, screw holes ± 0.1

Modello Type	Tipo Type	Alesaggio Cylinder bore	Corsa regolabile Adjustable stroke	Peso Weight	L1	L2	L3	L4	L5	Consumo aria (5 bar) Air consumption (5 bar)	Pressione d'esercizio Working pressure
		[mm.]	[mm.]	[kg]	[mm.]	[mm.]	[mm.]	[mm.]	[mm.]	[l]	[bar]
SLDS125.2-50	50	125	5 - 50	205	955	155	290	800	---	7,8	4 - 8
SLDS125.2-100	100		50-100	206	1005	205	340	800	---	14,7	
SLDS125.2-150	150		100-150	225	1155	255	390	900	26	21,8	
SLDS125.2-200	200		150-200	225	1205	305	440	900	76	28,7	
SLDS125.2-300	300		200-300	245	1405	405	540	1000	176	42,7	
SLDS125.2-400	400		300-400	265	1605	505	640	1100	276	56,6	
SLDS125.2-500	500		400-500	285	1805	605	740	1200	376	70,6	

** Carico max. applicabile (5 bar) ** Max. applicable load (5 bar)		Momento dinamico max. Dynamic torque max			Momento statico max. Static moment max.			Spinta max. Max. Thrust force (5 bar)
[kg]		[Nm]			[Nm]			[N]
Installazione orizzontale Horizontal installation	Installazione verticale Vertical installation	Mx	My	Mz	Mx	My	Mz	5820
600	180***	3500	2280	1300	4900	3190	2100	

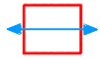

Dispositivo di scorrimento lineare con bloccaggio con chiusure Linear unit with clamps locking system

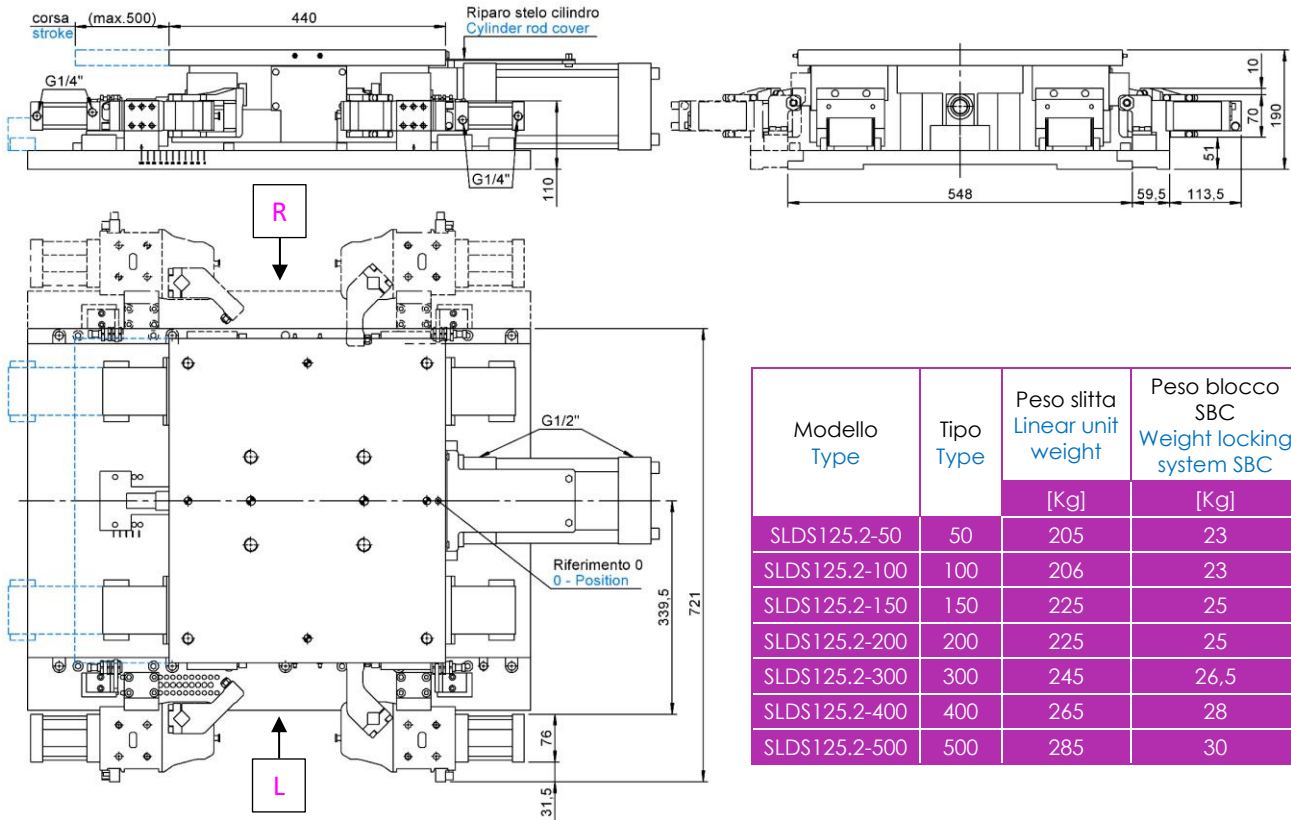

Modello Type	Tipo Type	Peso slitta Linear unit weight	Peso blocco SBC Weight locking system SBC
		[Kg]	[Kg]
SLDS125.2-50	50	205	23
SLDS125.2-100	100	206	23
SLDS125.2-150	150	225	25
SLDS125.2-200	200	225	25
SLDS125.2-300	300	245	26,5
SLDS125.2-400	400	265	28
SLDS125.2-500	500	285	30

Regolazione della corsa slitta Slide stroke adjustment

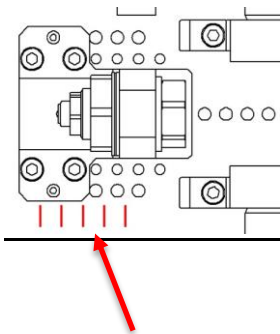

Macro Regolazione (Steps 10 mm.)

Fincorsa anteriore + deceleratore. Spostando la staffa (foratura sulla piastra base) è possibile modificare la corsa della slitta con un passo di 10 mm.

Coarse adjustment (Steps 10 mm.)

Front end stop + shock absorber. By moving the bracket (holes on the plate), the slide stroke can be changed in 10 mm. increments.

Modello Type	Corsa cilindro Cylinder stroke	Corsa slitta corta Short slide stroke	Corsa slitta lunga Long slide stroke
SLDS125.2-50	50	5 ÷ 50	
SLDS125.2-100	100		51 ÷ 100
SLDS125.2-150	150	101 ÷ 150	
SLDS125.2-200	200		151 ÷ 200
SLDS125.2-300	300	201 ÷ 250	251 ÷ 300
SLDS125.2-400	400	301 ÷ 350	351 ÷ 400
SLDS125.2-400	500	401 ÷ 450	451 ÷ 500

Nella tabella in alto sono indicate le varie tipologie di slitte con le relative corse massime e minime possibili.
The table above shows the various types of slides with their maximum and minimum possible strokes.

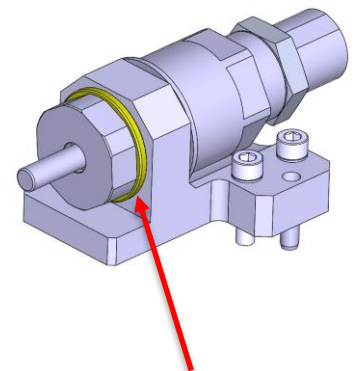

Micro Regolazione

Con spessori interposti tra la staffa e la ghiera. Sostituendo/aggiungendo spessori calibrati è possibile modificare la corsa. Spessori standard da 3/4/5 mm.

Fine adjustment

With Shims between bracket and ring nut. By replacing/adding calibrated shims, the stroke can be modified. Standard shims of 3/4/5 mm.

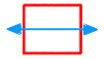

Schema per Finecorsa (cod. 3/191) Diagram for Limit switch (cod. 3/191)

Sensori di posizione Slitta Lineare Avanti e Indietro (Quantità : 2 pcs)

Caratteristiche tecniche :

- Tipo di uscita : PNP
- Tensione d'alimentazione : 10-30 VDC;
- Corrente max. di commutazione : 200 mA;
- Campo di temperatura : -25° / 70° C.



Forward and Backward Linear Slide Position Sensors (Quantity : 2 pcs)

Technical data :

- Output type : PNP
- Feeding voltage : 10-30 VDC;
- Max. commutating current : 200 mA;
- Temperature range : -25° / 70° C.

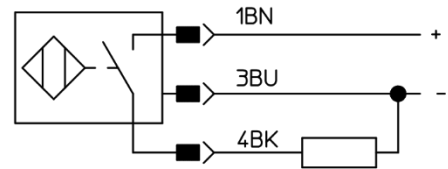

Schema per sensore induttivo CP40.3 (cod. 09538/1/C) Diagram for inductive sensor CP40.3 (cod. 09538/1/C)

Sensori sistema di bloccaggio SBC Power Clamps per Slitte Lineari SLDS63.2 e SLDS80.2 (Quantità : 2 pcs)

Sensors clamping system SBC Power Clamps for SLDS63.2 and SLDS80.2 linear slides (Quantity : 2 pcs)

Caratteristiche tecniche:

- Tipo di uscita : PNP
- Tensione d'alimentazione : 10-30 VDC;
- Corrente max. di commutazione : 200 mA;
- Consumo di corrente : < 25 mA;
- Calo di tensione : < 2 V
- Campo di temperatura : -25° / 70° C.

Technical data:

- Output type : PNP
- Feeding voltage : 10-30 VDC;
- Max. commutating current : 200 mA;
- Power supply : < 25 mA;
- Voltage drop : < 2 V;
- Temperature range : -25° / 70° C.

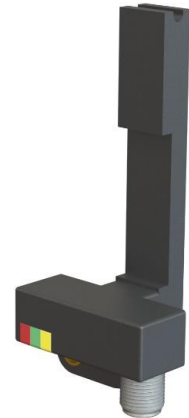
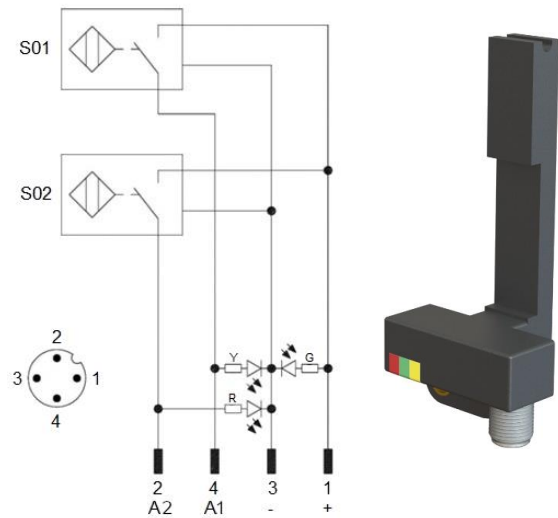

S02 = Segnale di chiusura

S02 = Closing signal

R = LED rosso / red LED

Tensione di esercizio

Operating voltage

G = LED verde / green LED

S01 = Segnale d'apertura

S01 = Opening signal

Y = LED giallo / yellow LED



Schema pneumatico.

Pneumatic plan.

Valvola di comando 5/2

Control valve 5/2

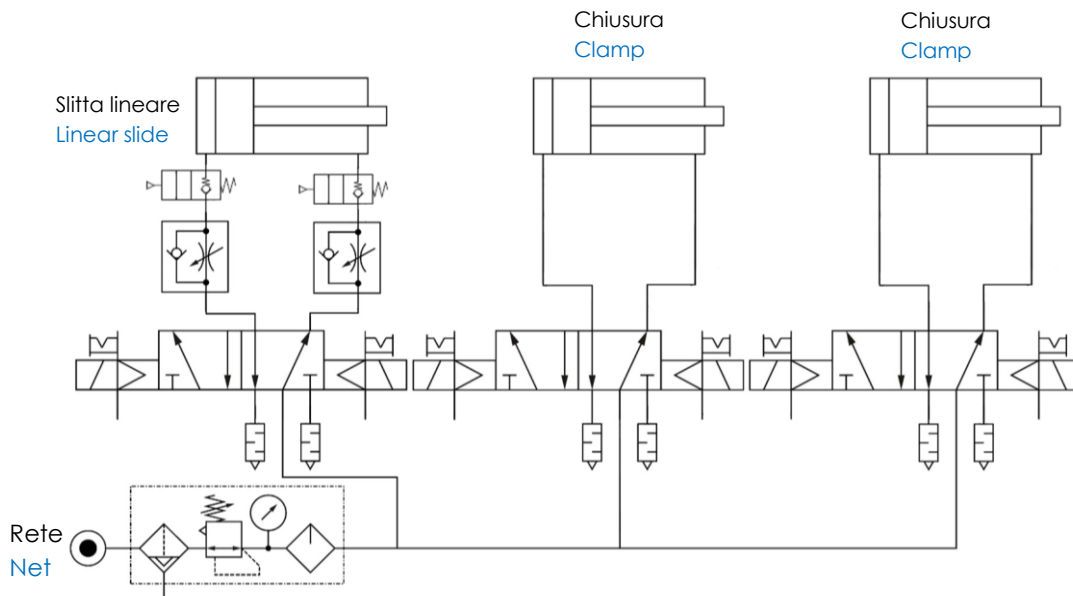

Consumo d'aria.

Air consumption

Corsa Stroke	Consumo d'aria (5 bar) Air consumption (5 bar)		
	SLDS63.2	SLDS80.2	SLDS125.2
[mm.]	[l]	[l]	[l]
50	3,3	4,4	9,8
100	5,0	7,3	16,8
150	6,8	10,2	23,7
200	8,6	13,0	30,7
300	12,1	18,8	44,7
400	15,7	24,5	58,7
500	19,2	30,2	72,6

Pressione d'esercizio
Working pressure







[bar]

4 – 8

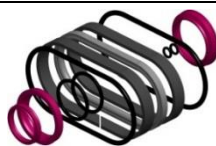
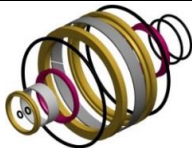

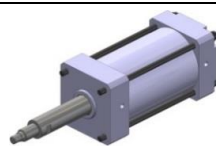
NB : si raccomanda l'utilizzo di aria secca non lubrificata.

Note : It's requesting to use unlubricated air and sand bank.

Ricambi.
Spare parts.

# Kit	Immagine Picture	Descrizione Description		Articolo Article
Kit guarnizioni Seals kit		SLDS63.2		SCR-SLD63.1
		SLDS80.2		SCR-SLD80.1
		SLDS125.2		SCR-SLD125.1
Cilindro pneumatico Pneumatic cylinder		SLDS63.2		07657/corsa/C 07657/stroke/C
		SLDS80.2		07669/corsa/C 07669/stroke/C
		SLDS125.2		07736/corsa/C 07736/stroke/C
Sensore induttivo chiusure (SBC) Clamp inductive sensor (SBC)		Finecorsa induttivo VEP completo (0°) Inductive proximity switch VEP (0°)	SLDS63.2 SLDS80.2	09538/1/C
			SLDS125.2	09127/1/C
Barra sensore Sensor bar		Barra satelliti sensore Sensor satellite bar	SLDS63.2 SLDS80.2	09538
			SLDS125.2	09127
Blocchetto amplificatore Sensor amplifier		Blocchetto amplificatore M12 connettore 0° Power sensor amplifier M12 connector 0°		3/436
Finecorsa (Pos) Limit switch (Pos)		SLDS63.2 SLDS 80.2 SLDS125.2		3/191

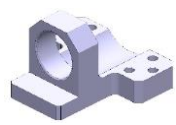
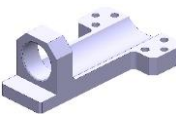

Deceleratore Shock absorber		SLDS63.2 / SLDS80.2		3/119
		SLDS125.2		3/163
Staffa corsa lunga Long stroke bracket		SLDS63.2		07663
		SLDS80.2		07676
		SLDS125.2		07735
Staffa corsa corta Short stroke bracket		SLDS63.2		08212
		SLDS80.2		08292
		SLDS125.2		07784
Spessori regolazione corsa Stroke adjustment shims		3 mm.		07790/3
		4 mm.		07790/4
		5 mm.		07790/5
Spessori regolazione corsa Stroke adjustment shims		0,5 mm.	SLDS63.2 / SLDS80.2	08598/0,5
			SLDS125.2	09322/0,5
		1 mm.	SLDS63.2 / SLDS80.2	08598/1
			SLDS125.2	09322/1
		2 mm.	SLDS63.2 / SLDS80.2	08598/2
			SLDS125.2	09322/2
Carrello Blocks		SLDS63.2		3/131/R
		SLDS80.2		3/135/R
		SLDS125.2		3/136/R

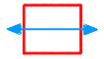

<p>Chiusura pneumatica Sistema di bloccaggio (SBC)</p> <p>Pneumatic clamp Locking system (SBC)</p>		<p>CP40.3 Leva G1C CP40.3 Arm G1C (SLDS63.2)</p>	<p>CP40.3 G1C I1 - 60</p>
		<p>CP40.3 Leva G1D CP40.3 Arm G1D (SLDS80.2)</p>	<p>CP40.3 G1D I1 - 60</p>
		<p>CP40.2 Leva G1S CP40.2 Arm G1S (SLDS80.2)</p>	<p>CP40.3 G1S I1 - 60</p>
		<p>CP50.1 Leva G1D CP50.1 Arm G1D (SLDS125.2)</p>	<p>CP50.1 G1D I1 - 45</p>
		<p>CP50.1 Leva G1S CP50.1 Arm G1S (SLDS125.2)</p>	<p>CP50.1 G1S I1 - 45</p>
<p>Kit Guarnizioni chiusure (SBC) Clamps seals Kit (SBC)</p>		<p>SLDS63.2 / SLD80.2</p>	<p>SCR-CPL40</p>
		<p>SLDS125.2</p>	<p>SCR-CPL50</p>

